



**RECORD OF TITLE  
UNDER LAND TRANSFER ACT 2017  
FREEHOLD  
Search Copy**



  
R. W. Muir  
Registrar-General  
of Land

**Identifier** SA24D/1274  
**Land Registration District** South Auckland  
**Date Issued** 27 April 1979

**Prior References**

SA799/48 SA895/129

---

**Estate** Fee Simple  
**Area** 2864 square metres more or less  
**Legal Description** Lot 1 Deposited Plan South Auckland  
26397

**Registered Owners**

SHSM Investments Limited

---

**Interests**

Subject to Section 15 of the Rotorua Town Lands Act 1920  
Subject to Section 387B (4) Municipal Corporations Act 1954  
12107595.3 Mortgage to ASB Bank Limited - 12.5.2021 at 4:22 pm

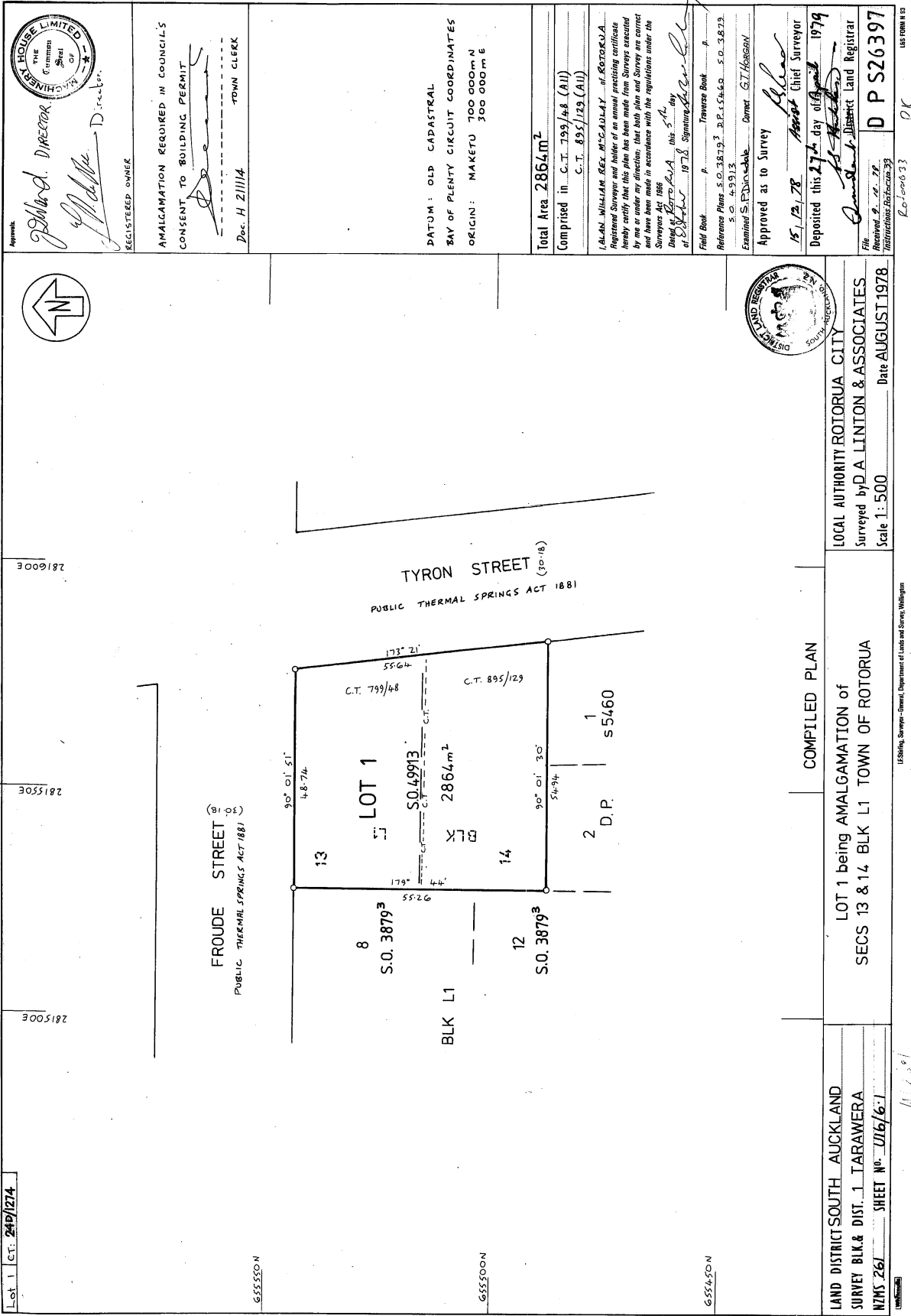

Approved: *[Signature]* DIRECTOR  
*[Signature]* District Registrar

REGISTERED OWNER  
 AMALGAMATION REQUIRED IN COUNCIL'S  
 CONSENT TO BUILDING PERMIT  
 Doc. H 211114  
 TOWN CLERK

DATUM: OLD CAPASTRAL  
 WAY OF PLENTY CIRCUIT COORDINATES  
 ORIGIN: MAKETU 100 000 m E  
 300 000 m E

Total Area 2864m<sup>2</sup>  
 Comprised in C.T. 799/48 (All)  
 C.T. 895/129 (All)

I, ALAN WILLIAM REX, M.C.A.D.L.A.Y., of ROTORUA, Registered Surveyor and holder of an annual practising certificate hereby certify that this plan has been made from surveys executed by me or under my direction; that both plan and survey are correct and have been made in accordance with the regulations under the Surveyors Act 1968  
 Signed at ROTORUA this 5th day of 12th 1985  
 1978 Signing *[Signature]*

Field Book: A  
 Traverse Book: A  
 Reference Plans: S.O. 38793, D.P. 15460, S.O. 3879, S.O. 43913  
 Examined: S.P. Dimmock, District Registrar

Approved as to Survey  
 15/12/85  
 District Chief Surveyor

Deposited this 27th day of August 1979  
 District Land Registrar  
 File: *[Signature]*  
 Received: 9.4.79  
 Instructions: District Registrar  
 D P S26397  
 15/12/85  
 PK



LOCAL AUTHORITY ROTORUA CITY  
 Surveyed by D.A. LINTON & ASSOCIATES  
 Scale 1: 500  
 Date AUGUST 1978

COMPILED PLAN  
 LOT 1 being AMALGAMATION of  
 SECS 13 & 14 BLK L1 TOWN OF ROTORUA

LAND DISTRICT SOUTH AUCKLAND  
 SURVEY BLK & DIST. 1 TARAWERA  
 NZMS 267  
 SHEET NO. 1216/6.1  
 11/3/81

15/12/85  
 District Chief Surveyor  
 15/12/85  
 District Chief Surveyor  
 15/12/85  
 District Chief Surveyor