

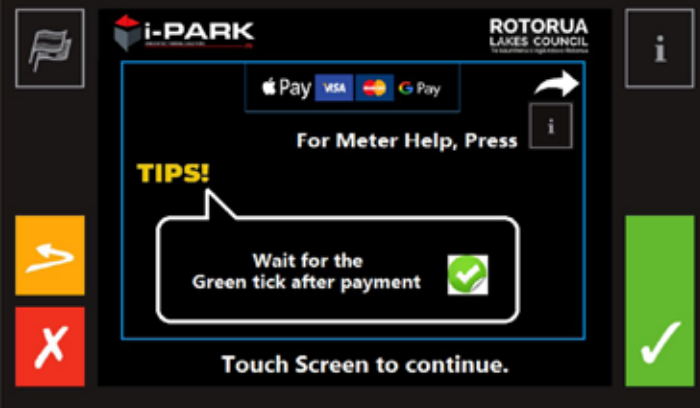

Inner city

parking information





1

How to use the payment machines

Touch screen to activate.
Or press this button.

Press the 'i' icon for more instructions.

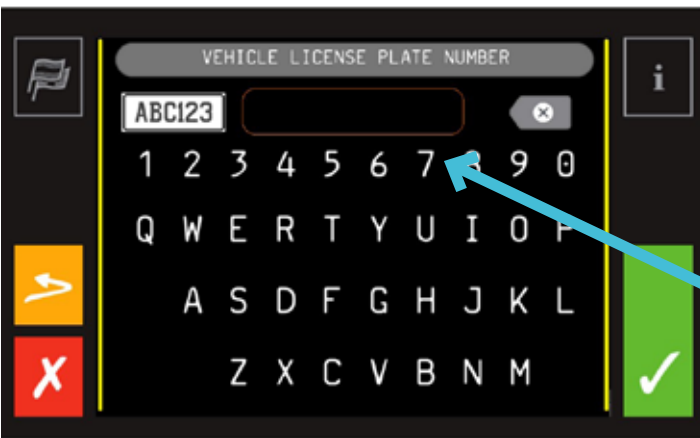

2

Enter your vehicle's number plate e.g



Tip: check that your number plate is entered correctly



3

Choose a receipt option.

You'll be asked to enter your email or mobile number after your payment is complete.

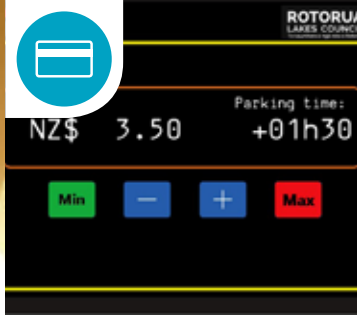

Choose a payment option.

Paying by coin:
Insert coins to increase time period.

Paying by card:
Select time period by pressing the **-** or **+** then scan or insert your card.



Wait for the tick and **“Transaction Complete”** message.

Note: if you do not see this screen, payment was not successful.

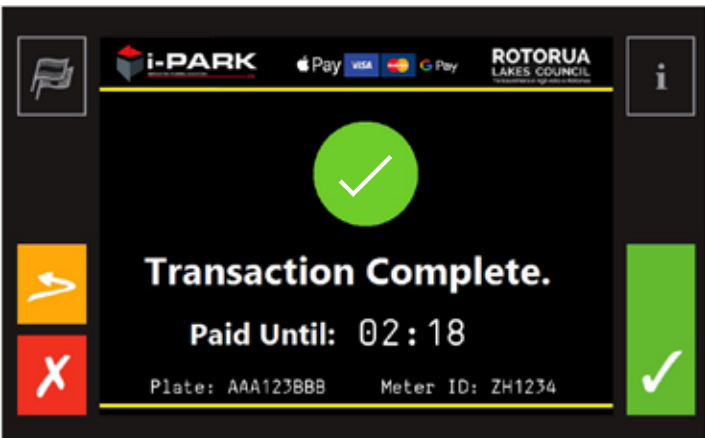

Enter email address or mobile number to receive your receipt.

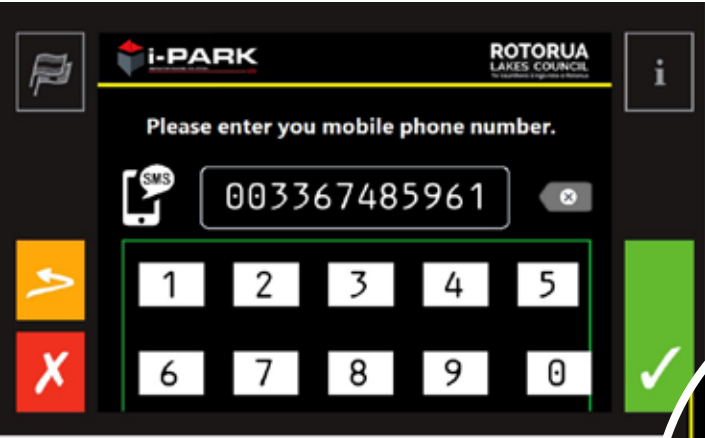

Payment Information

- Parking Tariff: \$1 per hour or \$4 per day in select Pink Zones.
- Pay by Credit/Debit Card or Cash (available at payment machines with Red Bands). Information about paying for parking with our app is detailed below.
- A 50c transaction fee applies for card payment.
- A 20c fee applies for SMS receipts. Email receipts are free.



Recent improvements:

Enhanced on-screen instructions

Enhancements have been made to the payment machines' screens - including more detailed information about how to use the parking system and payment machines. See inside this booklet for new instructions.

Easy to see coin payment machines

The machines that take coin payments have been fitted with red bands to make them more visible to drivers.

New Pink Zones - \$4 all day parking

The parking tariff will be reduced to a maximum of \$4 per day in some existing all day paid parking areas. These areas will become Pink Zones. The aim is to reduce pressure on inner city workers by providing better access to more low cost, all day parking solutions close to the CBD. The first Pink Zones will be introduced in early June 2020.

Improvements to Pukuatua Street parking building

i-Park has recently upgraded the technology and layout in the Pukuatua Street parking building. The new technology is ticketless (no more entry/exit tickets or concession cards!). The technology now detects your vehicle's number plate and lifts the barrier arm automatically. The building offers long and medium term parking options at a reduced rate plus \$6 all day casual parking. Visit i-park.co.nz/rotorua and select "Pukuatua Carpark" for more information

Introduction of a mobile app for parking

A parking app is now available. Search for PrestoPark in your app store. More information about using the app is available at i-park.co.nz/rotorua

Visit rotorualakescouncil.nz/parking for more information